

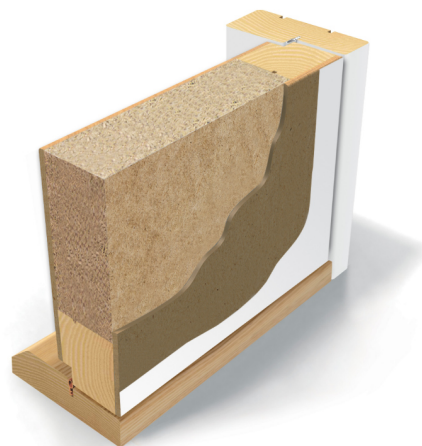

FD18-Sound is a wooden sound insulation door for use in heated work and living areas to close openings between sound insulating sections.

The temperature difference between the rooms to be separated must not exceed 5 ° C.



Sound insulation

Rw 38-40dB



## TECHNICAL DATA

Size	M7-10 x M20-21
Door leaf	non-rebated, 54mm thick
Frame	pine, thickness 92mm
Threshold	oak, height 25mm
Locking system	lock case ASSA 565 and striking plate LP712
Hinges	plate hinges Abloy 3248
Finishing	white (S 0502-Y) or special colour
Glass	laminated clear
Extras	additional lock case, doorbell, door eye, door closer, stainless steel kick plate, veneer cover, grooved patterns, adhesive decorative panels and/or moldings, descending threshold, postbox, glass inserts



LEFT

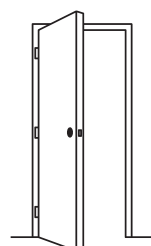

RIGHT

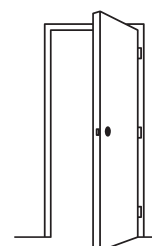

It is possible to get special solutions. More information from the representative.

	H	B	W	A	A1	A2
M7			690	625	606	550
M8			790	725	706	650
M9			890	825	806	750
M10			990	925	906	850
M20	1990	1940				
M21	2090	2040				

