

FD18 is a door for use in heated work and living areas to close openings between fire compartments.

The temperature difference between the rooms to be separated must not exceed 5 ° C.

Fire resistant	EI ₁₃₀
Smoke control	Sa/S ₂₀₀
Sound insulation	Rw 38-40dB
Self-closing class	C0-C5

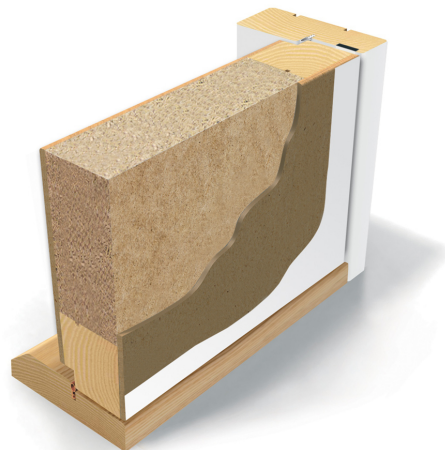

TECHNICAL DATA

Size	one sided M7-10 x M20-21 can be produced as a double-sided
Door leaf	non-rebated, thickness 54mm
Frame	pine, depth 92mm
Threshold	oak, height 25mm
Locking system	lock case ASSA 565 and striking plate LP712
Hinges	plate hinges Abloy 3248
Finishing	white (S 0502-Y) or special colour
Glass	clear fire glass
Extras	additional lock case, doorbell, door eye, surface mounted door closer, stainless steel kick plate, veneer cover, grooved patterns, glued decorative panels and/or moldings, descending threshold, postbox, glass insert

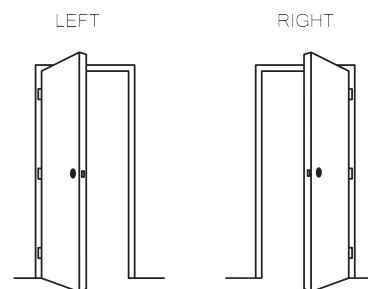

It is possible to get special solutions. More information from the representative.esindajalt.

	H	B	W	A	A1	A2
M7			690	625	606	550
M8			790	725	706	650
M9			890	825	806	750
M10			990	925	906	850
M20	1990	1940				
M21	2090	2040				

